

THIRD ANGLE PROJECTION

IF IN DOUBT ASK

ALL DIMENSIONS IN MM UNLESS OTHERWISE STATED

Ref	Qnt.	Revision	Date	Intro.	Apply
1		ORIGINAL/CC 16387	30/10/14	MN	

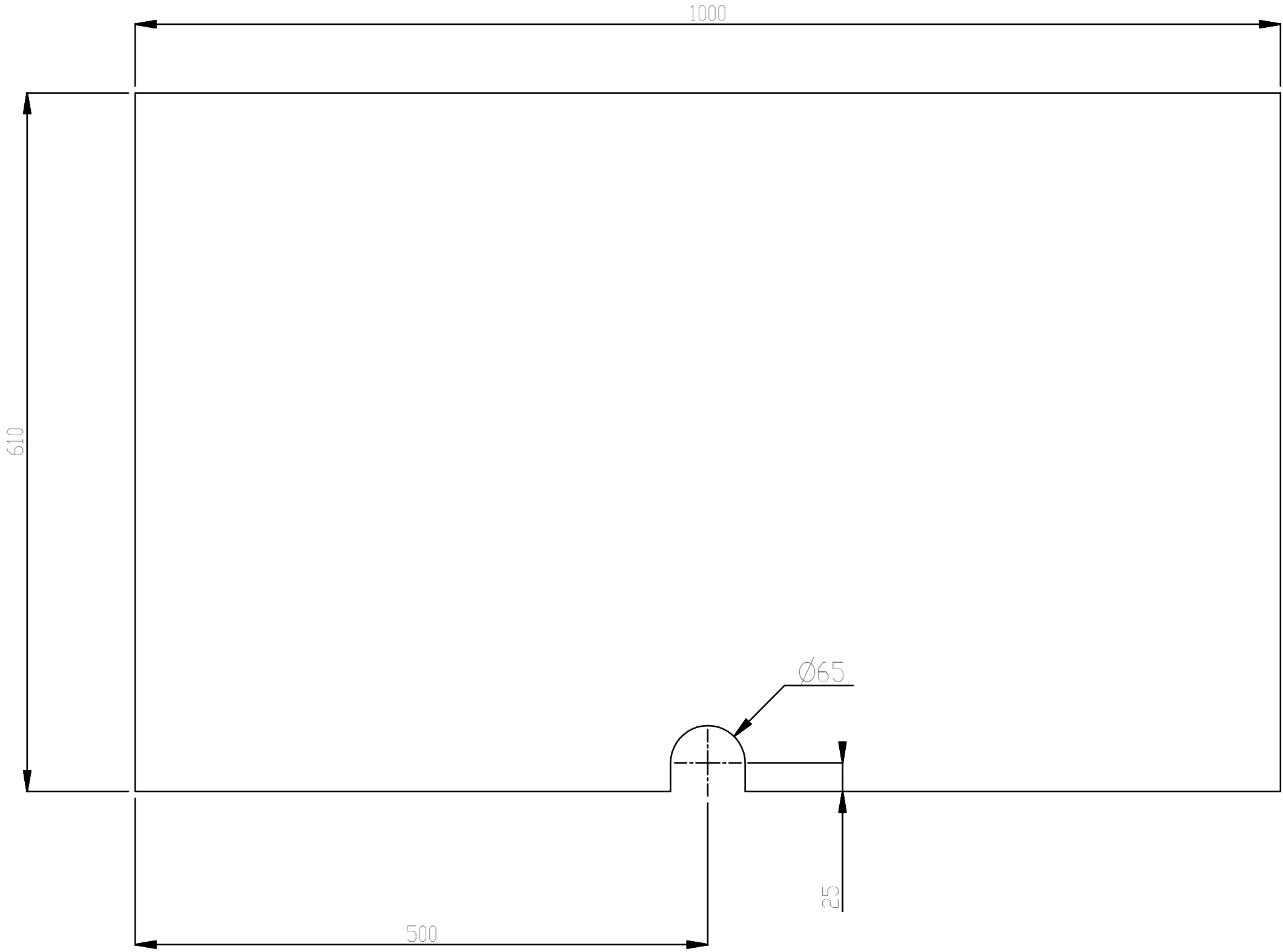

CUT LENGTH = 3307 mm
SURFACE AREA = 606 716 mm sq
MASS = 166.7 Kg

- NOTES:-
- REMOVE ALL BURRS & SHARP EDGES
 - TOLERANCES UNLESS OTHERWISE STATED:-
LINEAR UP TO 1000 ` 0.5
 OVER 1000 ` 1
ANGLES ` 0°30'

DIMENSIONS STATED TO FIRST DECIMAL PLACE ` 0.1

1		PLATE - BOTTOM			EN10025 S275JR	35 THK	STEEL PLATE	
Ref.no.	Qnt.	Part name			Material	Dimension	Remark	Component No.
Design by	Drawn by	Copied	Checked	Standard	Affirmed	Scale	Replace	Replaced by
MN	MN					NTS		
THIS DRAWING MUST NOT BE COPIED, REPRODUCED OR DISCLOSED TO ANY THIRD PARTY WITHOUT EXPRESS PERMISSION OF NIFTYLIFT LIMITED.			HR12N				File	Date
			MID PLATE - BOTTOM				K03988	30/10/14
							Drawing no.	