



THIRD ANGLE PROJECTION

IF IN DOUBT ASK

ALL DIMENSIONS IN MM UNLESS OTHERWISE STATED

POKUD NENÍ UVEDENO JINAK,
VŠE VÝŠE UVEDENÉ ROZMĚRY UVEDENY V MM.

| Ref. | Qty. | Revision | Date | Intro. | App. by |
|------|------|----------|----------|--------|---------|
| 2 | | CC11316 | 29/10/09 | GC | |
| 3 | | CC16097 | 22/10/14 | AB | |
| 4 | | CC16930 | 17/06/15 | MJ | |
| 5 | | CC17264 | 06/07/15 | GC | |

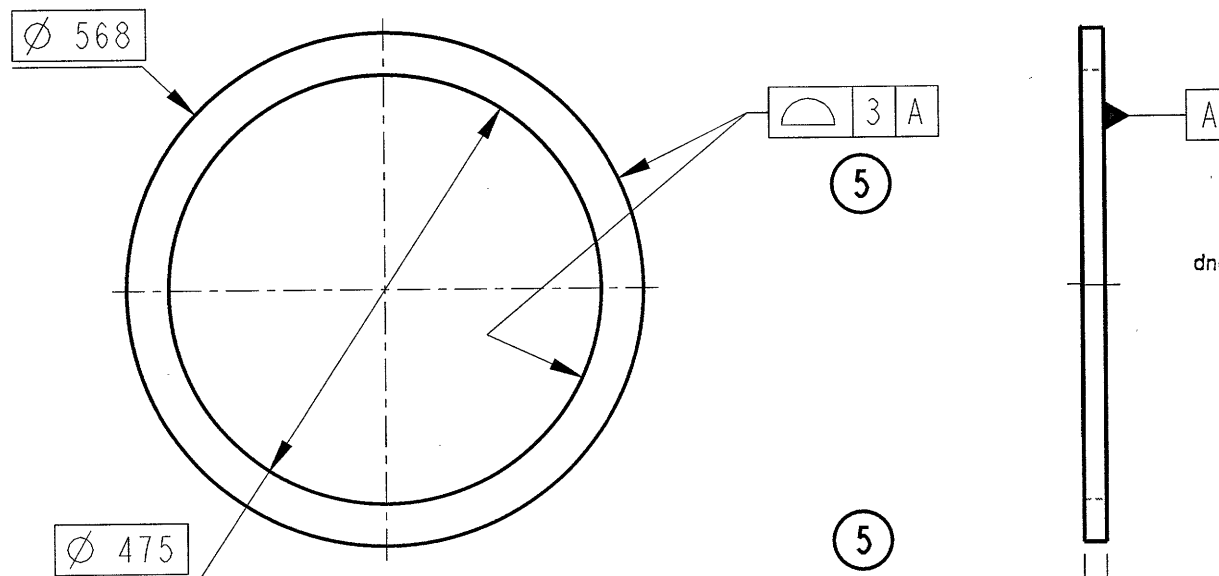

PŘEKLAD

dne: 04-04-2016

PROVEDL/A *Jan*
JANA PROKEŠOVÁ

NOTES:-

1. REMOVE ALL BURRS & SHARP EDGES

2. TOLERANCES UNLESS OTHERWISE STATED:-

LINEAR UP TO 1000 ± 0.5

OVER 1000 ± 1

ANGLES $\pm 0^{\circ} 30'$

DĚLKA ŘEZU

CUT LENGTH = 3277 mm

PLOCHA POUVĚHU

SURFACE AREA = 76183 mm²

- 4 -04- 2016

ARCHIV

24/16/00304

25 REF
SEE ASSY DRG.

nifty

NIFTYLIFT LIMITED

Fingle Drive, Stonebridge

Milton Keynes

Bucks MK13 0ER

Telephone:- 01908 223456; Telefax:- 01908 312733

SHEET 1 OF 1

| | | | | | | | | |
|--|-------------|--------|------------------|----------|----------|--------------|---------------|-------------|
| Material EN10025 S355J2+N | | | Dimension 25 THK | | | Remark PLATE | | |
| Design by DR | Drawn by GC | Copied | Checked | Standard | Affirmed | Scale NTS | Replace | Replaced by |
| THIS DRAWING MUST NOT BE COPIED, REPRODUCED OR DISCLOSED TO ANY THIRD PARTY WITHOUT EXPRESS PERMISSION OF NIFTYLIFT LIMITED. | | | | | | File K01076 | Date 29/04/09 | |
| SLEW ADAPTOR RING | | | | | | Drawing no. | K01076 | |