

PŘEKLAD

dne: 13. 09. 2013

PROVEDL/A

*J. Novotný*

Section A-A

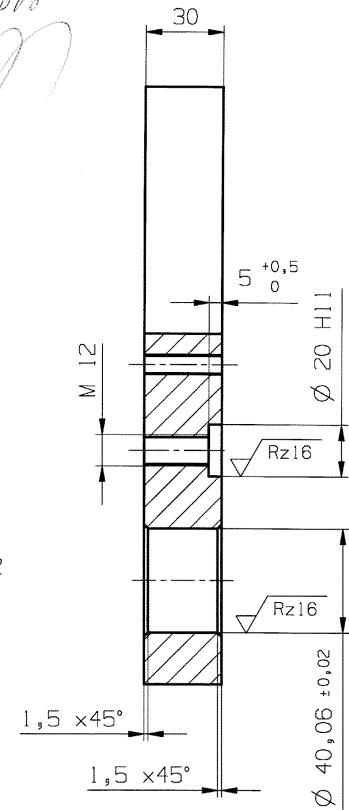

- 9 - 10 - 2013  
ARCHIV

0

N2 73/00460

General tolerances for laser cutting  
DIN 2310 - 5 -IL up to 3mm / -IK over 3mm  
General tolerances for nibbling / bending  
DIN 6930 - 2 - m

<b>kramerALLRAD</b> KRAMER-WERKE GMBH / D-88662 Überlingen		APPROVED FOR Welding Construction according to "Werknorm 43" Surface Quality according to "Werknorm 40" Theor. Weight according to "KR001-2003" Material according to "Werknorm 51"	
Projection see: ISO 128 Scale: 1:2 Original-Size: A3		Surface Quality Standard Color Name: KRAU_SCHMIGE Date: 11.07.2013 Count: 1 Change: 1 Material: BS03 Theor. Weight (kg): 14.88	
Band Tolerance see: DIN 6930 - 2 - m Welding Tolerance see: DIN EN ISO 13920-BF General Tolerance see: DIN ISO 2768 - mk Surface Condition see: DIN ISO 1302 Laser-Cut Tolerance see: DIN 2310-5-IL up to 3mm / -IK over 3mm Copyright reserved to ISO 16016		Name: Traverse Additional Text: Mat-Nr Doc-Nr: 2000137153 Version: 00	