

02A-ZM/16/01090-ZOBRAZEN SKUTEČNÝ TVAR DÍLCE S TECHNOLOGICKÝMI MŮSTKY.

21.10.2016 HRUBÝ

LASER cutting tolerances				
NOTA : min cutting radius without dimensions R = 1 mm unless otherwise specified				
≤ 30	30 < ≤ 120	120 < ≤ 400	400 < ≤ 1000	1000 <
± 0,5	± 0,8	± 1,0	± 1,5	± 2,0

Section A-A

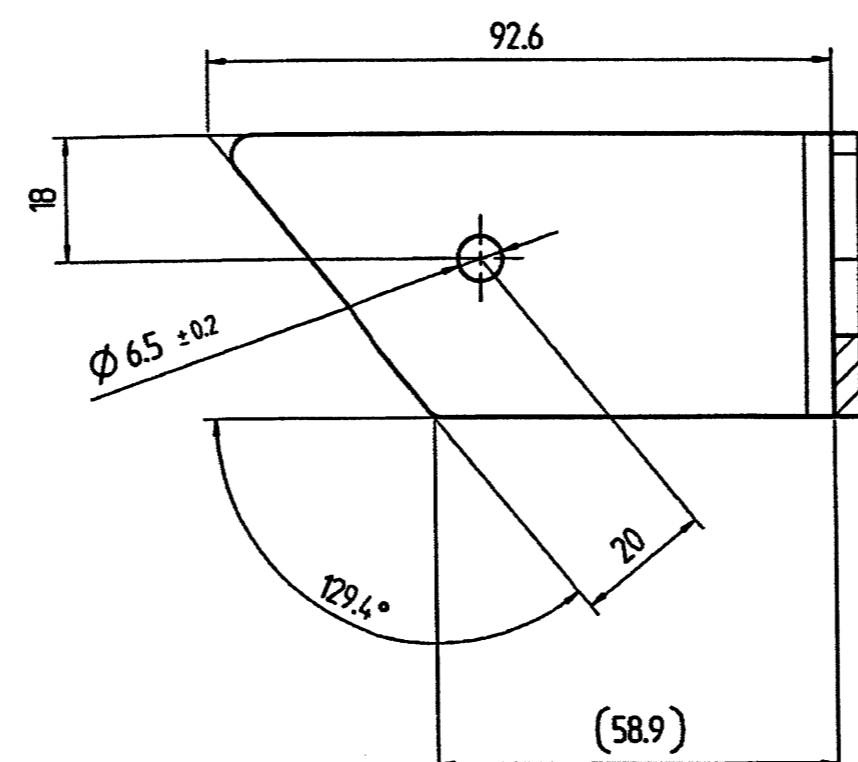

PŘEKŁAD

dne: 17. 12. 2014

PROVEDLIA

VRSOP

-3 -04- 2017
ARCHIV

4

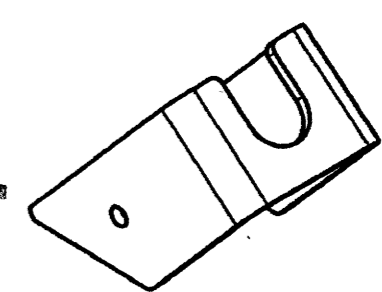

TRUVŠTVA NA T. KENOLIF. RÁDÍUSY RÁDÍUS OMIYBU

02B-ZM/17/00313-DOPLNĚNÝ KÓTY K OSÁM OHYBU NA LISTU Č.2

29.3.2017

HRUBÝ

NOTA :
- Metal sheet thickness : 4 mm
- Radii without dimension : R = 3
- Bend radii : R = 4
- Unfolded length (for info) = 1
DEJNA ZOVLOZENI

✓ N2 14/01402

Condition at time of delivery	
de-scaled (degree of purity SA 2 1/2 acc. ISO 8501-1)	X
without burrs acc. WN 11310	
Permissible top-end rounding during flame cutting (also positive bead acc. WN 10572)	
oil-free / free of grease	
oiled	
oiling permissible	X
Indicate the required condition at time of delivery with an X.	

First angle projection	02	Oiled --> Oiled permissible	148720
		Adding dim. 18 / Removing symmetrical	
General tolerance (GT) in mm	Index	alteration	Change no
Size range	Inspection dim.		Fit
≤ 30	≤ 120	≤ 400	≤ 1000
≤ 30	≤ 120	≤ 400	≤ 1000
GT coarse	Date	Name	Material: S235JR according to EN10025-2
L 1 2 2 3 4	Drawn 9.1.2014	JFonteny	Weight: 0.2
< 1 2 4 6	Checked 13.1.2014	F.Prausl	Blank no:
Lengths (L) and angle (L/L) = ±GT	Authid 22.1.2014	R.Pelletier	Title: support
	M.check 20.1.2014	J.LaCesne	emergency off switch
Tolerance Symbols ISO 1101			PROD. Scale 1:1
○ roundness = 1/2a-Tol.			Sheet: 1 of 2
-□ straightness/flatness = GT			
◎ concentricity/run out = GT			
≡ symmetry = GT			
// parallelism = GT			
⊕ position = GT			
Languages: en,fr	Confidential document	Refer to protection notice ISO 16011	Repl. 11914010911
			Org. 11914010911d001

Released

11914010911d001

A3