

SYM	PART NO.	PART NAME	QTY
	6114729M91	PIN W/ASSY	X
1	6114752M1	PIN FLAG	1
2	6114730M1	PIN	1

PŘEKŁAD
PROVEDLĀ
 dne: 28-02-2011
Prokoryn'

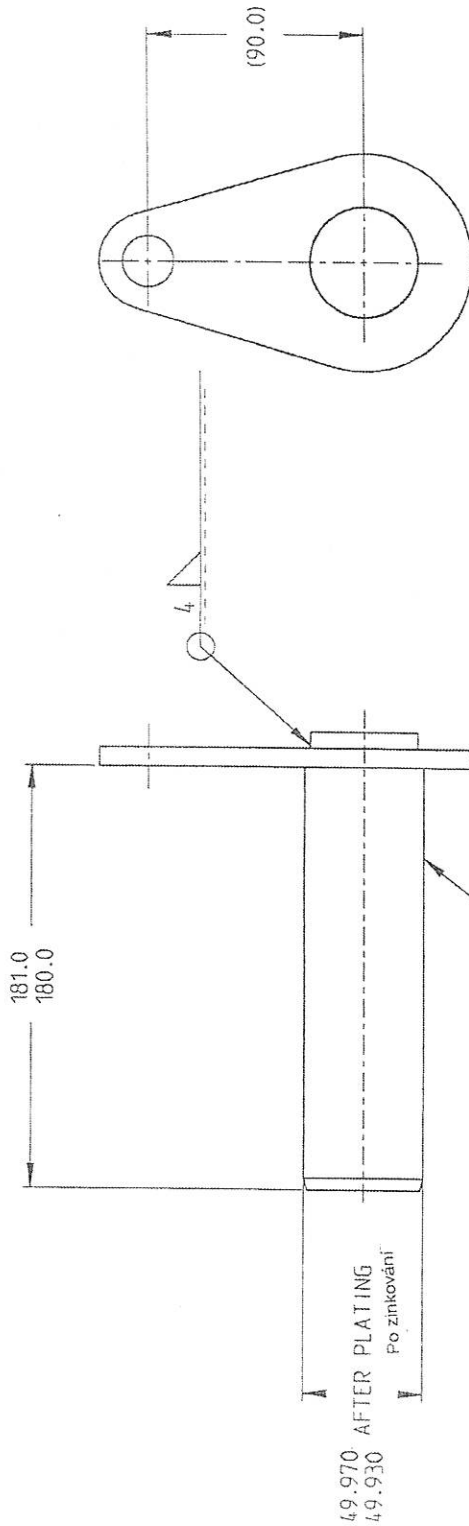

NAHRAZUJE ORIGINÁ

- Poznámky:**
1. Svařovat v souladu s normou CPS 303
 2. Všechny plochy bez rozstřiku - kuliček
 3. Zinkovat podle CMS M1047 část 2 nebo zinkovat a odvodňovat podle CMS M1047 část 2
 4. Rozměry po zinkování

NOTES:

1. ARC WELDING TO BE IN ACCORDANCE WITH CPS 303.
2. ALL AREAS TO BE FREE FROM WELD SPATTER.
3. ZINC PLATE TO CMS M1047 PART 2 OR ZINC PLATE & HYDROGEN RELIEF ANNEAL TO CMS M1047 PART 2.
4. ALL DIMENSIONS AFTER PLATING.

3D VIEW

PRODUCTION OF PARTS	DATE	BY	REV	DATE	BY
1	28-02-2011	PROKORYN'	1		
2			2		
3			3		
4			4		
5			5		
6			6		
7			7		
8			8		

ASSEMBLY	DATE	BY	REV	DATE	BY
1	28-02-2011	PROKORYN'	1		
2			2		
3			3		
4			4		
5			5		
6			6		
7			7		
8			8		

ASSEMBLY	DATE	BY	REV	DATE	BY
1	28-02-2011	PROKORYN'	1		
2			2		
3			3		
4			4		
5			5		
6			6		
7			7		
8			8		

ASSEMBLY	DATE	BY	REV	DATE	BY
1	28-02-2011	PROKORYN'	1		
2			2		
3			3		
4			4		
5			5		
6			6		
7			7		
8			8		

ASSEMBLY	DATE	BY	REV	DATE	BY
1	28-02-2011	PROKORYN'	1		
2			2		
3			3		
4			4		
5			5		
6			6		
7			7		
8			8		

ASSEMBLY	DATE	BY	REV	DATE	BY
1	28-02-2011	PROKORYN'	1		
2			2		
3			3		
4			4		
5			5		
6			6		
7			7		
8			8		

ASSEMBLY	DATE	BY	REV	DATE	BY
1	28-02-2011	PROKORYN'	1		
2			2		
3			3		
4			4		
5			5		
6			6		
7			7		
8			8		

ASSEMBLY	DATE	BY	REV	DATE	BY
1	28-02-2011	PROKORYN'	1		
2			2		
3			3		
4			4		
5			5		
6			6		
7			7		
8			8		

ASSEMBLY	DATE	BY	REV	DATE	BY
1	28-02-2011	PROKORYN'	1		
2			2		
3			3		
4			4		
5			5		
6			6		
7			7		
8			8		

ASSEMBLY	DATE	BY	REV	DATE	BY
1	28-02-2011	PROKORYN'	1		
2			2		
3			3		
4			4		
5			5		
6			6		
7			7		
8			8		

ASSEMBLY	DATE	BY	REV	DATE	BY
1	28-02-2011	PROKORYN'	1		
2			2		
3			3		
4			4		
5			5		
6			6		
7			7		
8			8		

ASSEMBLY	DATE	BY	REV	DATE	BY
1	28-02-2011	PROKORYN'	1		
2			2		
3			3		
4			4		
5			5		
6			6		
7			7		
8			8		

ASSEMBLY	DATE	BY	REV	DATE	BY
1	28-02-2011	PROKORYN'	1		
2			2		
3			3		
4			4		
5			5		
6			6		
7			7		
8			8		

ASSEMBLY	DATE	BY	REV	DATE	BY
1	28-02-2011	PROKORYN'	1		
2			2		
3			3		
4			4		
5			5		
6			6		
7			7		
8			8		

ASSEMBLY	DATE	BY	REV	DATE	BY
1	28-02-2011	PROKORYN'	1		
2			2		
3			3		
4			4		
5			5		
6			6		
7			7		
8			8		

ASSEMBLY	DATE	BY	REV	DATE	BY
1	28-02-2011	PROKORYN'	1		
2			2		
3			3		
4			4		
5			5		
6			6		
7			7		
8			8		

ASSEMBLY	DATE	BY	REV	DATE	BY
1	28-02-2011	PROKORYN'	1		
2			2		
3			3		
4			4		
5			5		
6			6		
7			7		
8			8		

ASSEMBLY	DATE	BY	REV	DATE	BY
1	28-02-2011	PROKORYN'	1		
2			2		
3			3		
4			4		
5			5		
6			6		
7			7		
8			8		

ASSEMBLY	DATE	BY	REV	DATE	BY
1	28-02-2011	PROKORYN'	1		
2			2		
3			3		
4			4		
5			5		
6			6		
7			7		
8			8		

ASSEMBLY	DATE	BY	REV	DATE	BY
1	28-02-2011	PROKORYN'	1		
2			2		
3			3		
4			4		
5			5		
6			6		
7			7		
8			8		

ASSEMBLY	DATE	BY	REV	DATE	BY
1	28-02-2011	PROKORYN'	1		
2			2		
3			3		
4			4		
5			5		
6			6		
7			7		
8			8		

ASSEMBLY	DATE	BY	REV	DATE	BY
1	28-02-2011	PROKORYN'	1		
2			2		
3			3		
4			4		
5			5		
6			6		
7			7		
8			8		

ASSEMBLY	DATE	BY	REV	DATE	BY
1	28-02-2011	PROKORYN'	1		
2			2		
3			3		
4			4		
5			5		
6			6		
7			7		
8			8		

ASSEMBLY	DATE	BY	REV	DATE	BY
1	28-02-2011	PROKORYN'	1		
2			2		
3			3		
4			4		
5			5		
6			6		
7			7		
8			8		

ASSEMBLY	DATE	BY	REV	DATE	BY
1	28-02-2011	PROKORYN'	1		
2			2		
3			3		
4			4		
5			5		
6			6		
7			7		
8			8		

ASSEMBLY	DATE	BY	REV	DATE	BY
1	28-02-2011	PROKORYN'	1		
2			2		
3			3		
4			4		
5			5		
6			6		
7			7		
8			8		

ASSEMBLY	DATE	BY	REV	DATE	BY
1	28-02-2011	PROKORYN'	1		
2			2		
3			3		
4			4		
5			5		
6			6		
7			7		
8			8		

ASSEMBLY	DATE	BY	REV	DATE	BY
1	28-02-2011	PROKORYN'	1		
2			2		
3			3		
4			4		
5			5		
6			6		
7			7		
8			8		

ASSEMBLY	DATE	BY	REV	DATE	BY
1	28-02-2011	PROKORYN'	1		
2			2		
3			3		
4			4		
5			5		
6			6		
7			7		
8			8		

ASSEMBLY	DATE	BY	REV	DATE	BY
1	28-02-2011	PROKORYN'	1		
2			2		
3			3		
4			4		
5			5		
6			6		
7			7		
8			8		

ASSEMBLY	DATE	BY	REV	DATE	BY
1	28-02-2011	PROKORYN'	1		
2			2		
3			3		
4			4		
5			5		
6			6		
7			7		
8			8		

ASSEMBLY	DATE	BY	REV	DATE	BY
----------	------	----	-----	------	----

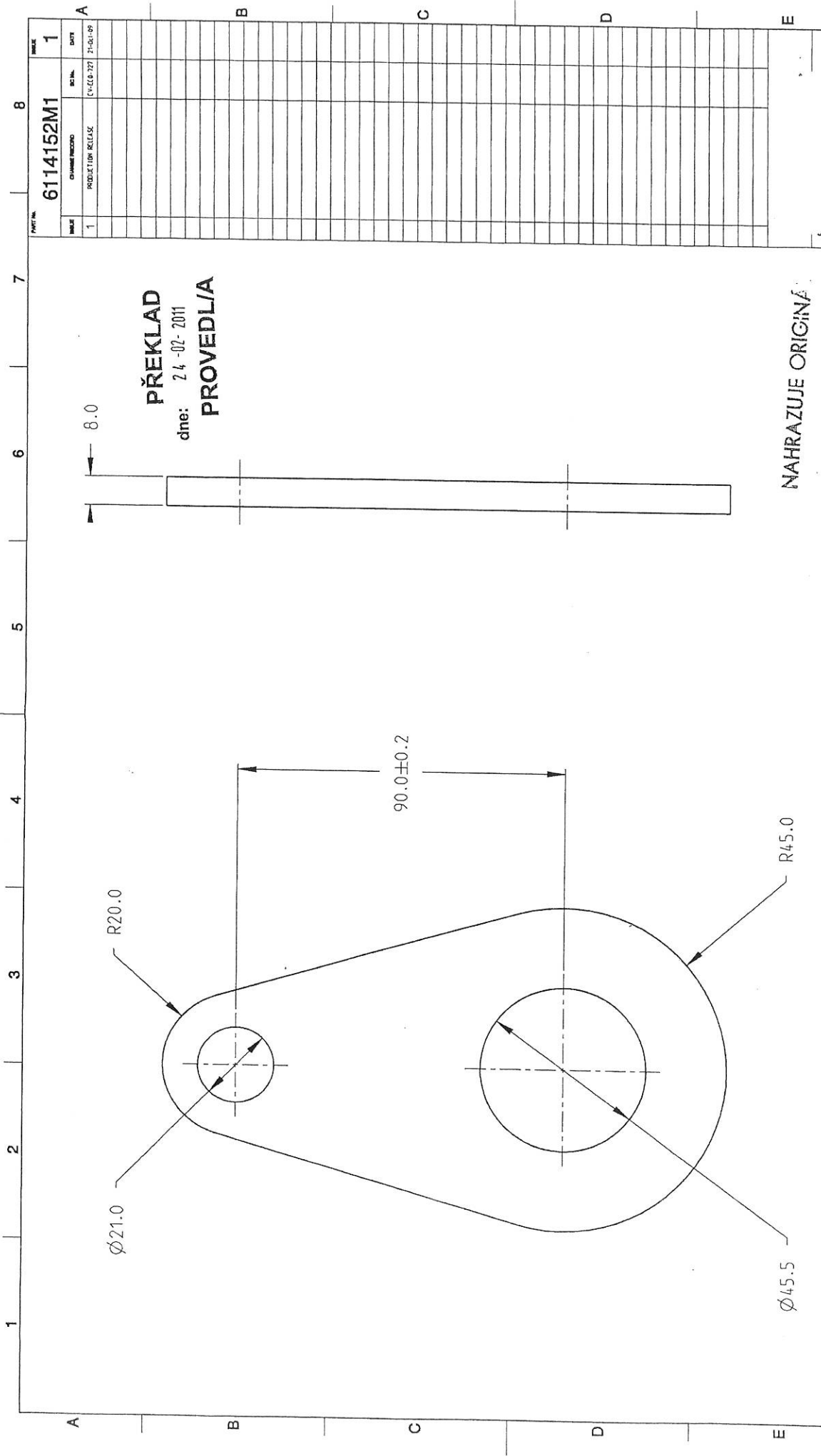

NAHRAZUJE ORIGINÁL

21. pros. 2009

REMOVE ALL BURRS & SHARP EDGES
ODSTRANIT VŠECHNY OTRŽEPY A OSTRÉ HRANY

DESIGN	DATE	03-10-08
APPROVED	DATE	
CONTROL	COVENTRY	
THIRD ANGLE PROJECTION		
NAME		
PIN FLAG		
MATERIAL		
STEEL TO BS EN10025 S355 JR		
PART NO.		
6114152M1		
REV		
1		

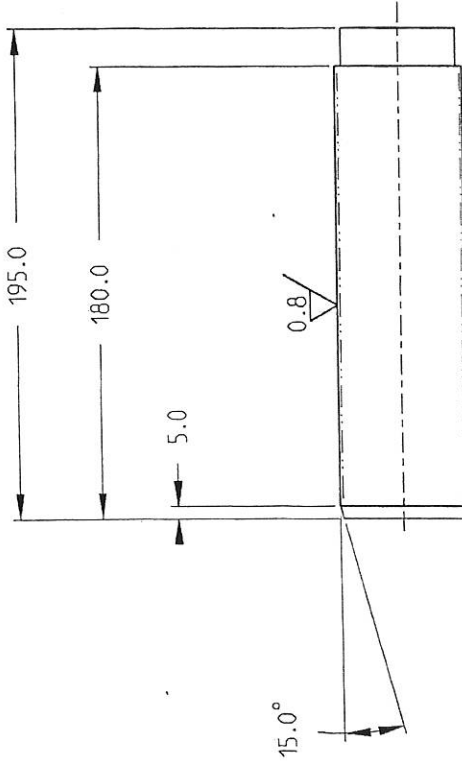

HEAT TREATMENT ZONE
Tepelně zpracovaná plocha

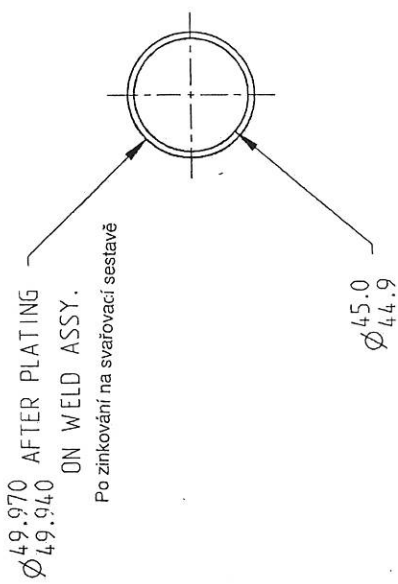

Ø49.970 AFTER PLATING
Ø49.940 ON WELD ASSY.

Po zinkování na svařovací sestavě

PŘEKLAD
dne: 28-02-2011
PROVEDLÍ
Začetová m

12.5 (✓)
4/4

- Poznámky:**
- Indukční kalit do 1,6 až 2,3 efektivní hloubky. Tvrdost povrchu HRC 54-60. Mechanické vlastnosti jádra musí splňovat požadavky podle BS970 „T“.
 - Všechny uvedené rozměry po zinkování
 - Indukční kalená zóna bez feritu.
 - Alternativní materiál – EN 10083 42CrMo4 (obsah uhlíku 0,4-0,45)

NOTES:

- INDUCTION HARDEN 1.6 TO 2.3 EFFECTIVE DEPTH. TEMPER SURFACE TO ROCKWELL “C” 54-60. CORE MECHANICAL PROPERTIES TO COMPLY WITH BS970 “T” REQUIREMENTS.
- ALL DIMENSIONS SHOWN AFTER PLATING.
- INDUCTION HARDENED ZONE TO BE FREE OF FERRITE.
- ALTERNATIVE MATERIAL – EN 10083 42CRM04 (CARBON 0.4-0.45) CARBON RESTRICTED SPECIFICATION.

NAHAZUJE ORIGINAL

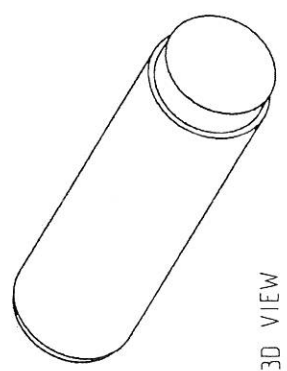

3D VIEW

TOTAL NUMBER OF DIMENSIONS AND LINE IDENTIFICATION SPECIFIED				SCALE				SHEET				MATERIAL			
NO.	TYPE	UNIT	VALUE	NO.	TYPE	UNIT	VALUE	NO.	TYPE	UNIT	VALUE	NO.	TYPE	UNIT	VALUE
1	OVER	mm	195.0	1	OVER	mm	180.0	1	OVER	mm	5.0	1	OVER	mm	49.970
2	TO	mm	180.0	2	TO	mm	180.0	2	TO	mm	5.0	2	TO	mm	49.940
3	AT	mm	5.0	3	AT	mm	5.0	3	AT	mm	5.0	3	AT	mm	5.0
4	ON	mm	5.0	4	ON	mm	5.0	4	ON	mm	5.0	4	ON	mm	5.0
5	ON	mm	5.0	5	ON	mm	5.0	5	ON	mm	5.0	5	ON	mm	5.0
6	ON	mm	5.0	6	ON	mm	5.0	6	ON	mm	5.0	6	ON	mm	5.0
7	ON	mm	5.0	7	ON	mm	5.0	7	ON	mm	5.0	7	ON	mm	5.0
8	ON	mm	5.0	8	ON	mm	5.0	8	ON	mm	5.0	8	ON	mm	5.0
9	ON	mm	5.0	9	ON	mm	5.0	9	ON	mm	5.0	9	ON	mm	5.0
10	ON	mm	5.0	10	ON	mm	5.0	10	ON	mm	5.0	10	ON	mm	5.0
11	ON	mm	5.0	11	ON	mm	5.0	11	ON	mm	5.0	11	ON	mm	5.0
12	ON	mm	5.0	12	ON	mm	5.0	12	ON	mm	5.0	12	ON	mm	5.0
13	ON	mm	5.0	13	ON	mm	5.0	13	ON	mm	5.0	13	ON	mm	5.0
14	ON	mm	5.0	14	ON	mm	5.0	14	ON	mm	5.0	14	ON	mm	5.0
15	ON	mm	5.0	15	ON	mm	5.0	15	ON	mm	5.0	15	ON	mm	5.0
16	ON	mm	5.0	16	ON	mm	5.0	16	ON	mm	5.0	16	ON	mm	5.0
17	ON	mm	5.0	17	ON	mm	5.0	17	ON	mm	5.0	17	ON	mm	5.0
18	ON	mm	5.0	18	ON	mm	5.0	18	ON	mm	5.0	18	ON	mm	5.0
19	ON	mm	5.0	19	ON	mm	5.0	19	ON	mm	5.0	19	ON	mm	5.0
20	ON	mm	5.0	20	ON	mm	5.0	20	ON	mm	5.0	20	ON	mm	5.0
21	ON	mm	5.0	21	ON	mm	5.0	21	ON	mm	5.0	21	ON	mm	5.0
22	ON	mm	5.0	22	ON	mm	5.0	22	ON	mm	5.0	22	ON	mm	5.0
23	ON	mm	5.0	23	ON	mm	5.0	23	ON	mm	5.0	23	ON	mm	5.0
24	ON	mm	5.0	24	ON	mm	5.0	24	ON	mm	5.0	24	ON	mm	5.0
25	ON	mm	5.0	25	ON	mm	5.0	25	ON	mm	5.0	25	ON	mm	5.0
26	ON	mm	5.0	26	ON	mm	5.0	26	ON	mm	5.0	26	ON	mm	5.0
27	ON	mm	5.0	27	ON	mm	5.0	27	ON	mm	5.0	27	ON	mm	5.0
28	ON	mm	5.0	28	ON	mm	5.0	28	ON	mm	5.0	28	ON	mm	5.0
29	ON	mm	5.0	29	ON	mm	5.0	29	ON	mm	5.0	29	ON	mm	5.0
30	ON	mm	5.0	30	ON	mm	5.0	30	ON	mm	5.0	30	ON	mm	5.0
31	ON	mm	5.0	31	ON	mm	5.0	31	ON	mm	5.0	31	ON	mm	5.0
32	ON	mm	5.0	32	ON	mm	5.0	32	ON	mm	5.0	32	ON	mm	5.0
33	ON	mm	5.0	33	ON	mm	5.0	33	ON	mm	5.0	33	ON	mm	5.0
34	ON	mm	5.0	34	ON	mm	5.0	34	ON	mm	5.0	34	ON	mm	5.0
35	ON	mm	5.0	35	ON	mm	5.0	35	ON	mm	5.0	35	ON	mm	5.0
36	ON	mm	5.0	36	ON	mm	5.0	36	ON	mm	5.0	36	ON	mm	5.0
37	ON	mm	5.0	37	ON	mm	5.0	37	ON	mm	5.0	37	ON	mm	5.0
38	ON	mm	5.0	38	ON	mm	5.0	38	ON	mm	5.0	38	ON	mm	5.0
39	ON	mm	5.0	39	ON	mm	5.0	39	ON	mm	5.0	39	ON	mm	5.0
40	ON	mm	5.0	40	ON	mm	5.0	40	ON	mm	5.0	40	ON	mm	5.0
41	ON	mm	5.0	41	ON	mm	5.0	41	ON	mm	5.0	41	ON	mm	5.0
42	ON	mm	5.0	42	ON	mm	5.0	42	ON	mm	5.0	42	ON	mm	5.0
43	ON	mm	5.0	43	ON	mm	5.0	43	ON	mm	5.0	43	ON	mm	5.0
44	ON	mm	5.0	44	ON	mm	5.0	44	ON	mm	5.0	44	ON	mm	5.0
45	ON	mm	5.0	45	ON	mm	5.0	45	ON	mm	5.0	45	ON	mm	5.0
46	ON	mm	5.0	46	ON	mm	5.0	46	ON	mm	5.0	46	ON	mm	5.0
47	ON	mm	5.0	47	ON	mm	5.0	47	ON	mm	5.0	47	ON	mm	5.0
48	ON	mm	5.0	48	ON	mm	5.0	48	ON	mm	5.0	48	ON	mm	5.0
49	ON	mm	5.0	49	ON	mm	5.0	49	ON	mm	5.0	49	ON	mm	5.0
50	ON	mm	5.0	50	ON	mm	5.0	50	ON	mm	5.0	50	ON	mm	5.0
51	ON	mm	5.0	51	ON	mm	5.0	51	ON	mm	5.0	51	ON	mm	5.0
52	ON	mm	5.0	52	ON	mm	5.0	52	ON	mm	5.0	52	ON	mm	5.0
53	ON	mm	5.0	53	ON	mm	5.0	53	ON	mm	5.0	53	ON	mm	5.0
54	ON	mm	5.0	54	ON	mm	5.0	54	ON	mm	5.0	54	ON	mm	5.0
55	ON	mm	5.0	55	ON	mm	5.0	55	ON	mm	5.0	55	ON	mm	5.0
56	ON	mm	5.0	56	ON	mm	5.0	56	ON	mm	5.0	56	ON	mm	5.0
57	ON	mm	5.0	57	ON	mm	5.0	57	ON	mm	5.0	57	ON	mm	5.0
58	ON	mm	5.0	58	ON	mm	5.0	58	ON	mm	5.0	58	ON	mm	5.0
59	ON	mm	5.0	59	ON	mm	5.0	59	ON	mm	5.0	59	ON	mm	5.0
60	ON	mm	5.0	60	ON	mm	5.0	60	ON	mm	5.0	60	ON	mm	5.0
61	ON	mm	5.0	61	ON	mm	5.0	61	ON	mm	5.0	61	ON	mm	5.0
62	ON	mm	5.0	62	ON	mm	5.0	62	ON	mm	5.0	62	ON	mm	5.0
63	ON	mm	5.0	63	ON	mm	5.0	63	ON	mm	5.0	63	ON	mm	5.0
64	ON	mm	5.0	64	ON	mm	5.0	64	ON	mm	5.0	64	ON	mm	5.0
65	ON	mm	5.0	65	ON	mm	5.0	65	ON	mm	5.0	65	ON	mm	5.0
66	ON	mm	5.0	66	ON	mm	5.0	66	ON	mm	5.0	66	ON	mm	5.0
67	ON	mm	5.0	67	ON	mm	5.0	67	ON	mm	5.0	67	ON	mm	5.0
68	ON	mm	5.0	68	ON	mm	5.0	68	ON	mm	5.0	68	ON	mm	5.0
69	ON	mm	5.0	69	ON	mm	5.0	69	ON	mm	5.0	69	ON	mm	5.0
70	ON	mm	5.0	70	ON	mm	5.0	70	ON	mm	5.0	70	ON	mm	5.0
71	ON	mm	5.0	71	ON	mm	5.0	71	ON	mm	5.0	71	ON	mm	5.0
72	ON	mm	5.0	72	ON	mm	5.0	72	ON	mm	5.0	72	ON	mm	5.0
73	ON	mm	5.0	73	ON	mm	5.0	73	ON	mm	5.0	73	ON	mm	5.0
74	ON	mm	5.0	74	ON	mm	5.0	74	ON	mm	5.0	74	ON	mm	5.0
75	ON	mm	5.0	75	ON	mm	5.0	75	ON	mm	5.0	75	ON	mm	5.0
76	ON	mm	5.0	76	ON	mm	5.0	76	ON	mm	5.0	76	ON	mm	5.0
77	ON	mm	5.0	77	ON	mm	5.0	77	ON	mm	5.0	77	ON	mm	5.0
78	ON	mm	5.0	78	ON	mm	5.0	78	ON	mm	5.0	78	ON	mm	5.0
79	ON	mm	5.0	79	ON	mm	5.0	79	ON	mm	5.0	79	ON	mm	5.0
80	ON	mm	5.0	80	ON	mm	5.0	80	ON	mm	5.0	80	ON	mm	5.0
81	ON	mm	5.0	81	ON	mm	5.0	81	ON	mm	5.0	81	ON	mm	5.0
82	ON	mm	5.0	82	ON	mm	5.0	82	ON	mm	5.0	82	ON	mm	5.0
83	ON	mm	5.0	83	ON	mm	5.0	83	ON	mm	5.0	83	ON	mm	5.0
84	ON	mm	5.0	84	ON	mm	5.0	84	ON	mm	5.0	84	ON	mm	5.0
85	ON	mm	5.0	85	ON	mm	5.0	85	ON	mm	5.0	85	ON	mm	5.0
86	ON	mm	5.0	86	ON	mm	5.0	86	ON	mm	5.0	86	ON	mm	5.0
87	ON	mm	5.0	87	ON	mm	5.0	87	ON	mm	5.0	87	ON	mm	5.0
88	ON	mm	5.0	88	ON	mm	5.0	88	ON	mm	5.0	88	ON	mm	5.0
89	ON	mm	5.0	89	ON	mm	5.0	89	ON	mm	5.0	89	ON	mm	5.0
90	ON	mm	5.0	90	ON	mm	5.0	90	ON	mm	5.0	90	ON	mm	5.0
91	ON	mm	5.0	91	ON	mm	5.0	91	ON	mm	5.0	91	ON	mm	5.0
92	ON	mm	5.0	92	ON	mm	5.0	92	ON	mm	5.0	92	ON	mm	5.0
93	ON	mm	5.0	93	ON	mm	5.0	93	ON	mm	5.0	93	ON	mm	5.0
94	ON	mm	5.0	94	ON	mm	5.0	94	ON	mm	5.0	94	ON	mm	5.0
95	ON	mm	5.0	95	ON	mm	5.0	95	ON	mm	5.0	95	ON	mm	5.0
96	ON	mm	5.0	96	ON	mm	5.0	96	ON	mm	5.0	96	ON	mm	5.0
97	ON	mm	5.0	97	ON	mm	5.0	97	ON	mm	5.0	97	ON	mm	5.0