

ŘEZ A-A
SCHNITT A-A

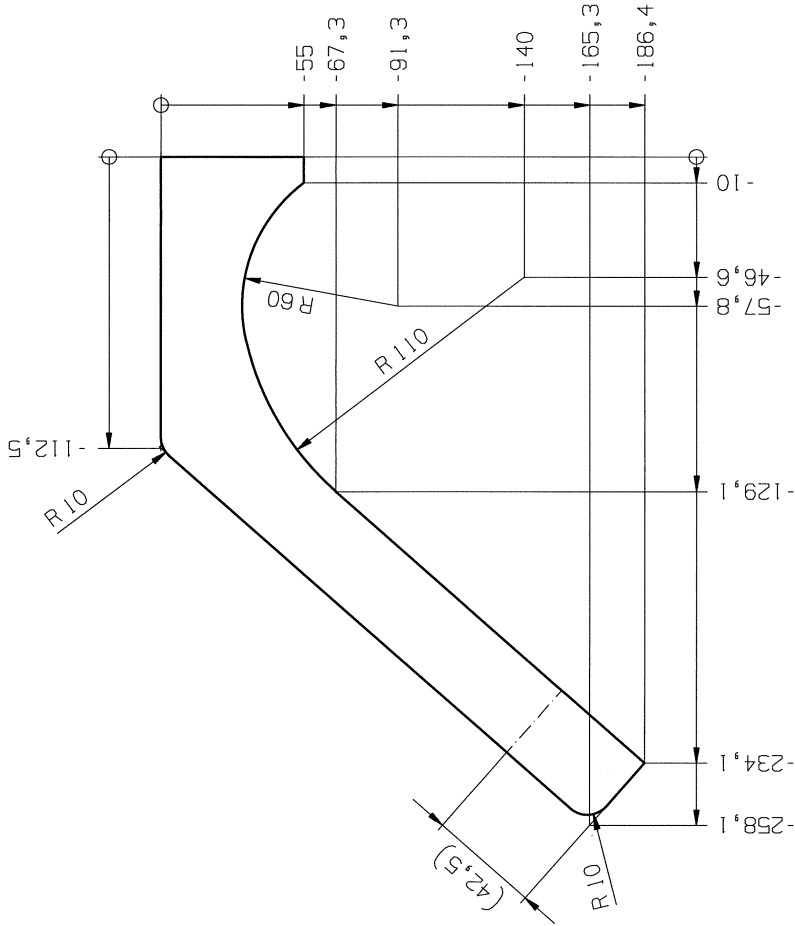
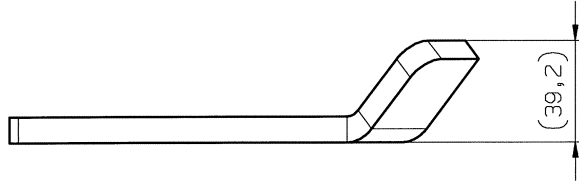
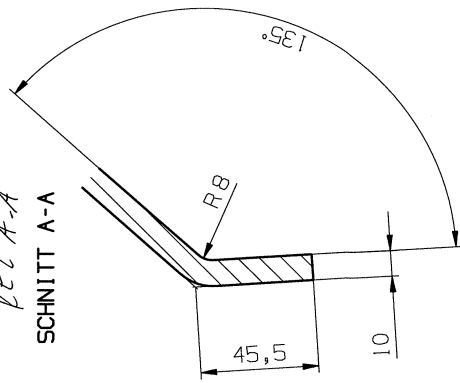

PŘEKLAD

dně: 17. 05. 2013

PROVEDLÍ

Kraus
Joska

0

5-06-2013
ARCHIV

VŠEOBECNÉ TOLERANCE PRO
ŘEZÁNÍ LASEREM

Allgemeintoleranzen Laserschneiden
DIN 2310 - 5 -IL bis 3mm / -IK über 3mm
Allgemeintoleranzen Nibbeln / Biegen
DIN 6930 - 2 - m

VŠEOBECNÉ TOLERANCE
PRO VÁSTŘIMÁNÍ
CHYBAMI

APPROVED FOR				Prototypenfrei (F2)			
Projection see: ISO 128				Welding Construction according to "Werknorm 4.3"			
Scale				Surface Quality according to "Werknorm 4.0"			
1:2				Theor. Weight according to "KR001-2003"			
Original-Size				Material according to "Werknorm 5"			
A3				KRAU-SCHMIG			
Surface Quality				Name			
Standard Color				Date			
Name				26.04.2013			
Count				Theor. Weight (kg)			
KRAU-SCHMIG				Material: BS10			
Name				Versteifung			
Additional Text				Mat-Nr.			
DIN 6930 - 2 - m				Doc-Nr.			
Bend Tolerance see DIN 6930 - 2 - m				2000132316			
Welding Tolerance see DIN EN ISO 1990-BF				Version			
General Tolerance see DIN ISO 2768 - m				00			
Surface Condition see DIN ISO 1502							
Laser-Cut Tolerance see DIN 2310-5-L up to 3mm / -K over 3mm							
Copyright reserved to ISO 16016							